

UNDER CAR PARTS

Description:

The rear suspension on a 'W' body vehicle incorporates a transverse leaf spring. This "Fiberglass" spring has two "molded-on" rubber blocks located outboard on the spring. These blocks sit in the knuckle at the rear hub assemblies to provide cushion for the spring.

Problem:

These blocks can wear out in two to three years or less, dependent on road and weather conditions. The only replacements from G.M. come with a new spring. The spring complete with blocks costs approx. \$700-800. If the blocks are not replaced the following problems occur: The spring, now in direct contact with the metal surface will make noise and will start to crack and deteriorate. This will mean eventually changing the spring.

Solution:

Our Teflon Friction Blocks **Part #15512** are made of hard wearing, self lubricating teflon and are an easy and inexpensive fix for the problem .

Instructions:

Unload the rear spring one side at a time. Remove any worn rubber material from the spring & knuckle. Remove any sand or grit from the knuckle. Place the friction block with the grooved side down in the knuckle.

Model	Year	Part No.
General Motors:		
Buick Regal	1988-96	15512
Chevrolet Lumina	1988-96	15512
Chevrolet Monte Carlo	1988-96	15512
Oldsmobile Cutlass Supreme	1988-96	15512
Pontiac Grand Prix	1988-96	15512

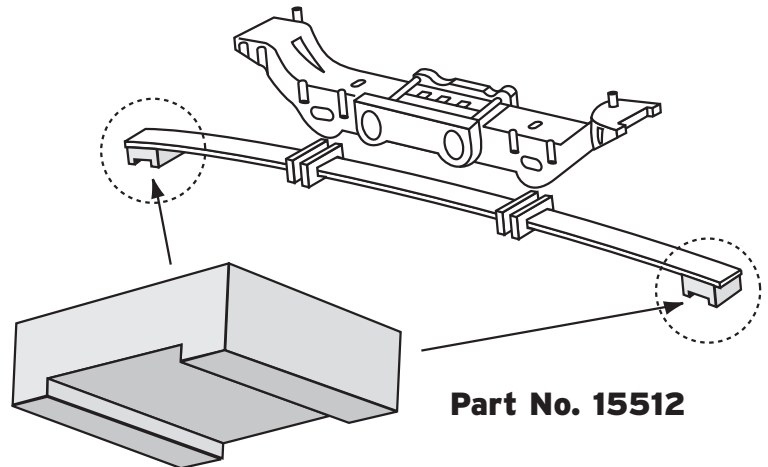

LH Replacement Sleeve

This adjustable sleeve is designed to replace the knurled adjusting sleeve on 1998 and up Chrysler LHS, Concorde, 300M and the Dodge Intrepid. This improved sleeve can be adjusted with a hex wrench. This sleeve is recommended when the sleeve has been damaged or if the tie rod end is being replaced so adjustments can be made more easily.

Application	Year	Part No.
Chrysler: 300M, Concorde LHS	1998 & up	15500
Dodge: Intrepid	1998 & up	15500

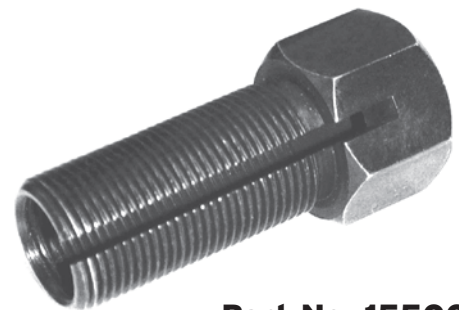

Part No. 15500

Alignment Cam Guide Pins

- OEGuide pin brake off and there in no OE replacement pin
- Fast and easy to install
- 4X4 and 4X2 applications

Application	Year	Part No.
General Motors: Chevy Truck 4X4 & 4X2 GMC Truck Hummer H2	1999 - 05	15505

